

NETTVERK

Trimble Brukermøte 2019



Nyheter i 3D armering

Presenter

- Michal Modrzynski
 - Managing Director
 - EDRMedeso POLSKA sp. z o. o.
 - michal.modrzynski@edrmedeso.com



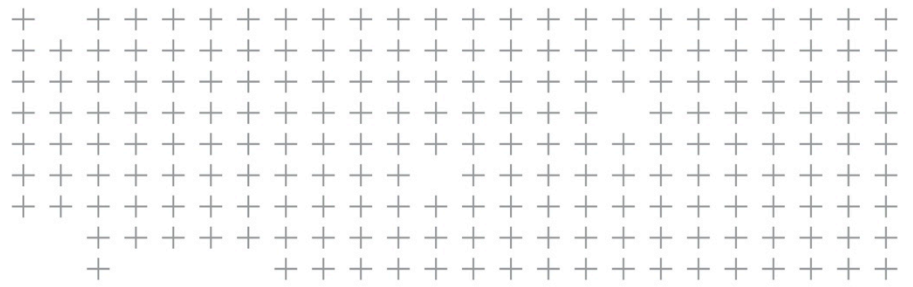

Rebar sets

Gammel Rebar groups vs Ny Rebar sets

Gammel Rebar groups

- Punkt basert input
- Single bars
- Rebar Groupps
 - Ungroup og Regroup til endre gruppering
- Remodellering av armering hvis feil valg av pekkepunkter
- Vanskelig å modellere jern midt i betongelementer med pekkepunkter

Rebar sets

- Geometribasert input
- Automatisk gruppering
- Du kan legge til leg face til å endre geometrien
- Dynamisk kontroll av utbedelseslinjer
- Du kan legge til:
 - Bars
 - Bae faces
 - Bar face edges

Armerings egenskaper

- Overdekkning innstillinger
 - Topp
 - Bunn
 - Sider
- Avrunding
 - Rette jern
 - Først og sist
 - mellomligende
 - Splitter avrunding
- Trapp og trinn armering
 - Same kontroll muligheter som avrunding bortsett fra splitter

Options

Save Load standard Save as

Clash check
Components
Drawing dimensions
Drawing objects
General
Load modeling
Numbering
Orientation marks
Reinforcement
Units and decimals

Concrete cover

Top	25.00
Bottom	25.00
Sides	25.00

Minimum lengths to be created

Minimum bar length	Distance	0.00
Minimum straight start/end leg length	Distance	200.00

Rounding

Straight bars	Up	5.00
First and last legs	Up	5.00
Intermediate legs	Up	5.00
Rounding up in splitters		5.00

Step tapering

Straight bars	50.00
First and last legs	50.00
Intermediate legs	50.00

Warning: If you change these settings, use the Regenerate rebar sets command to update the affected reinforcement.

Advanced... OK Apply Cancel

Rebar Set nivå egenskaper

- Automatisk lag plassering
 - Ingen behov for overdekkning
- Avstand kontrollert med soner
- Rebar Set nivå avrunding
 - Overstyrer egenskaper vindu
- Rebar Set nivå Trapp og trinn
 - Antall jern
 - Størrelse

Rebar set (1 selected)

▼ Attributes

Numbering: 1

Name: LINKS

Grade: Undefined

Size: 10

Bending radius: [20.00 mm]

Class: 2

Layer order number: -1

▼ Spacing properties

Start offset: Minimum [31.00 mm]

End offset: Minimum [31.00 mm]

▼ Spacing zone 1

Length: Relative 100% 5000.00 mm

Number of spaces: Target 10

Spacing: Exact 200.00 mm

▼ Custom properties

More: More

▼ Advanced

▼ Rounding

Straight bars: []

First and last legs: []

Intermediate legs: []

Rounding up at splitters: []

▼ Step tapering

Type: None

Straight bars: []

First and last legs: []

Intermediate legs: []

Modify []

Modifiell kontroll

- Påvirker hver andre, tredje, og fjerde
- Krokker
 - Standard krok
 - Bruker definert krok
 - Krok rotasjon
- Lengde justering
 - Leg length
 - Offsett
- Ende forberedelse for skjøtting

Rebar end detail modifier (1 selected)

▼ General

Bars affected 1/1

First affected bar Auto

▼ Hook

Hook type Standard 90-degrees

Angle 90.00

Radius 40.00 mm

Length 80.00 mm

Hook rotation 180.00

▼ Length adjustment

Adjustment type

Length

▼ End preparations

Method

Type

Product

Code

Thread type

Threaded length

Extra fabrication length

▼ Custom properties

More More

Rebar sets: Endre utbredelseslinje ved innsetting

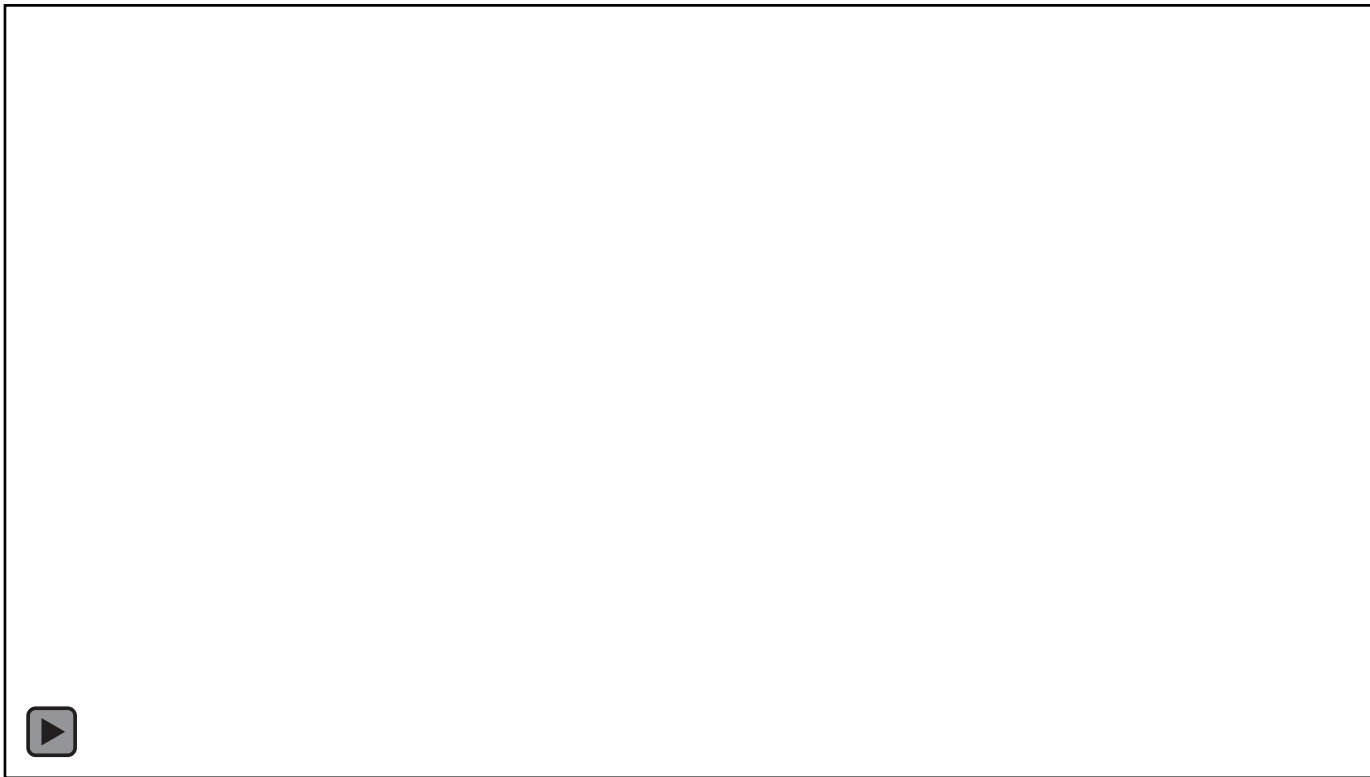



Rebar sets: Kutt erkjennelse

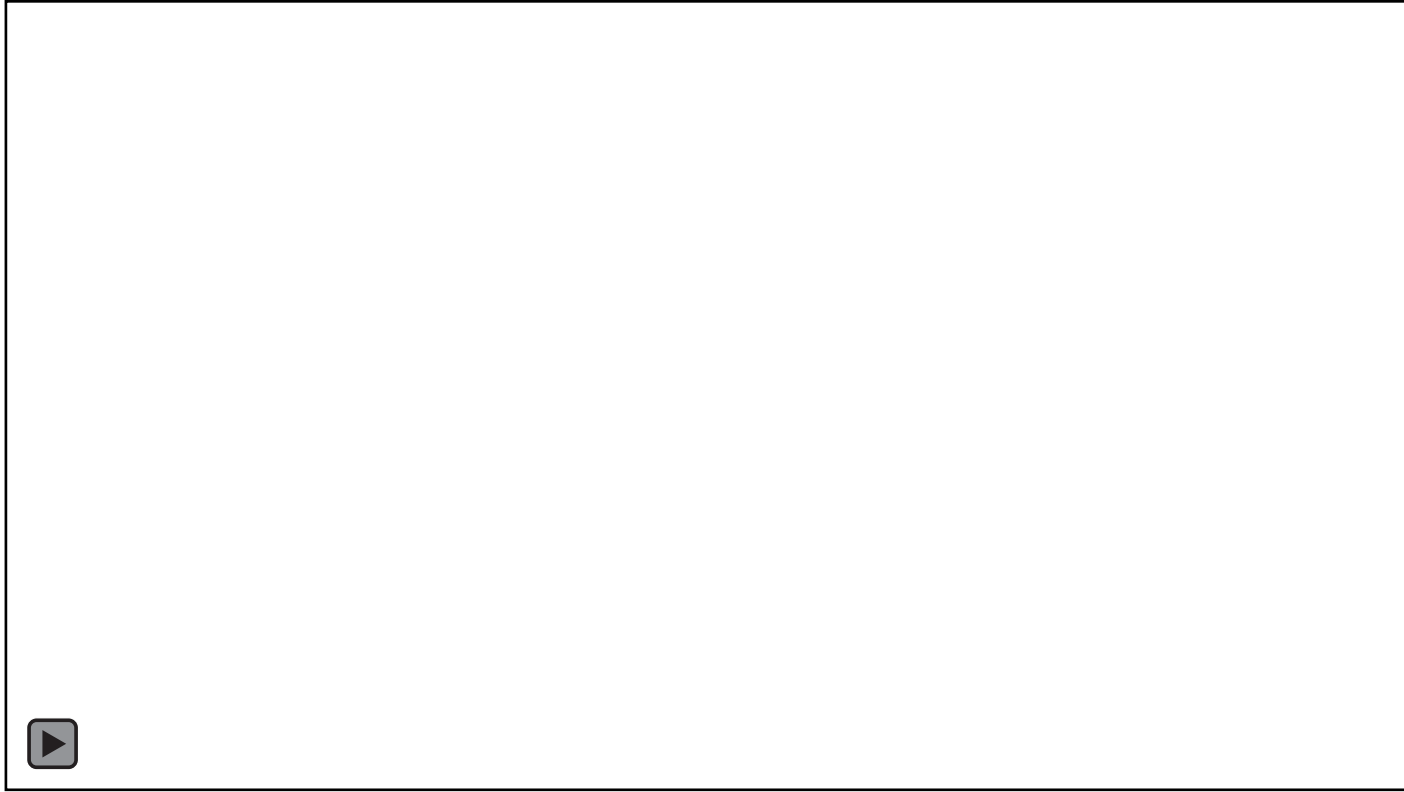



Rebar sets: Innerkontur erkjennelse

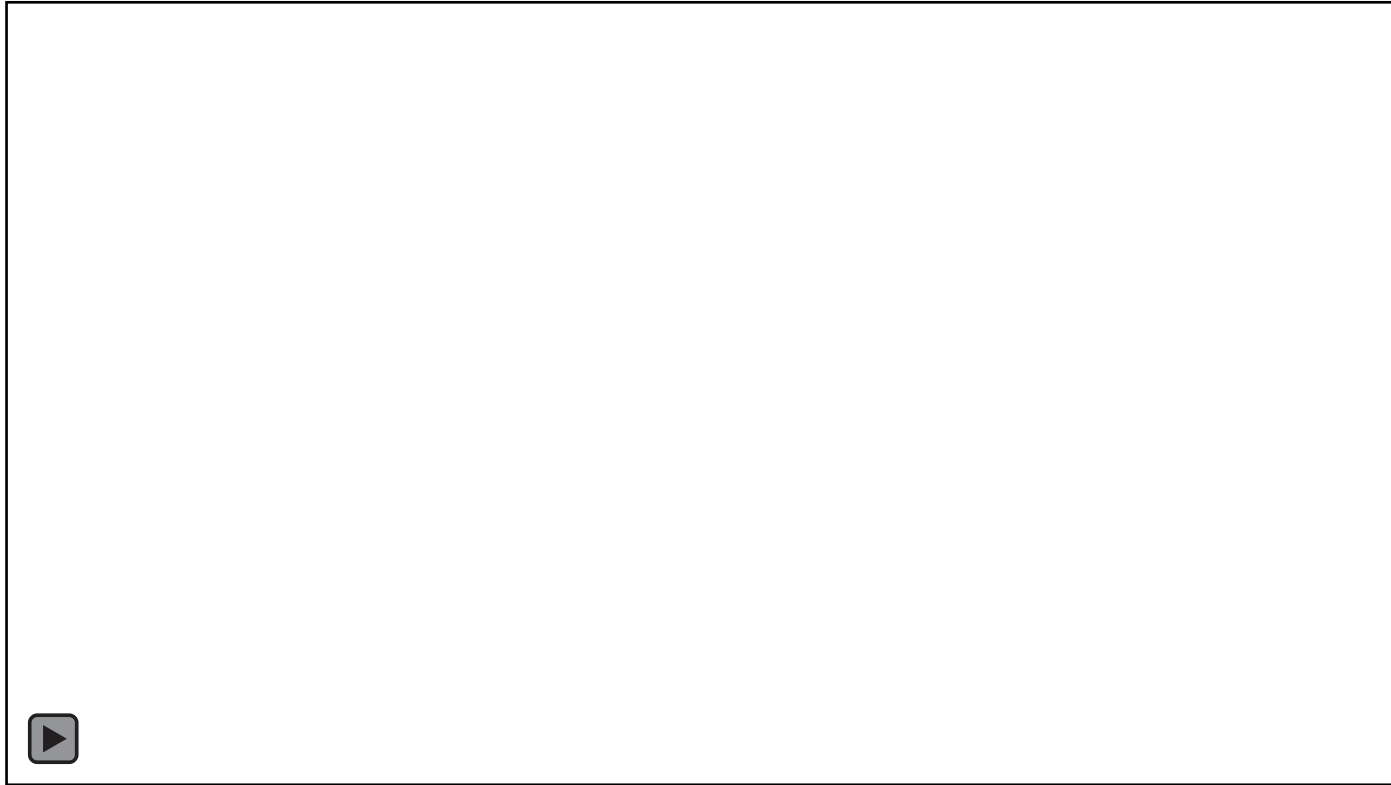



Rebar sets: Avrunding

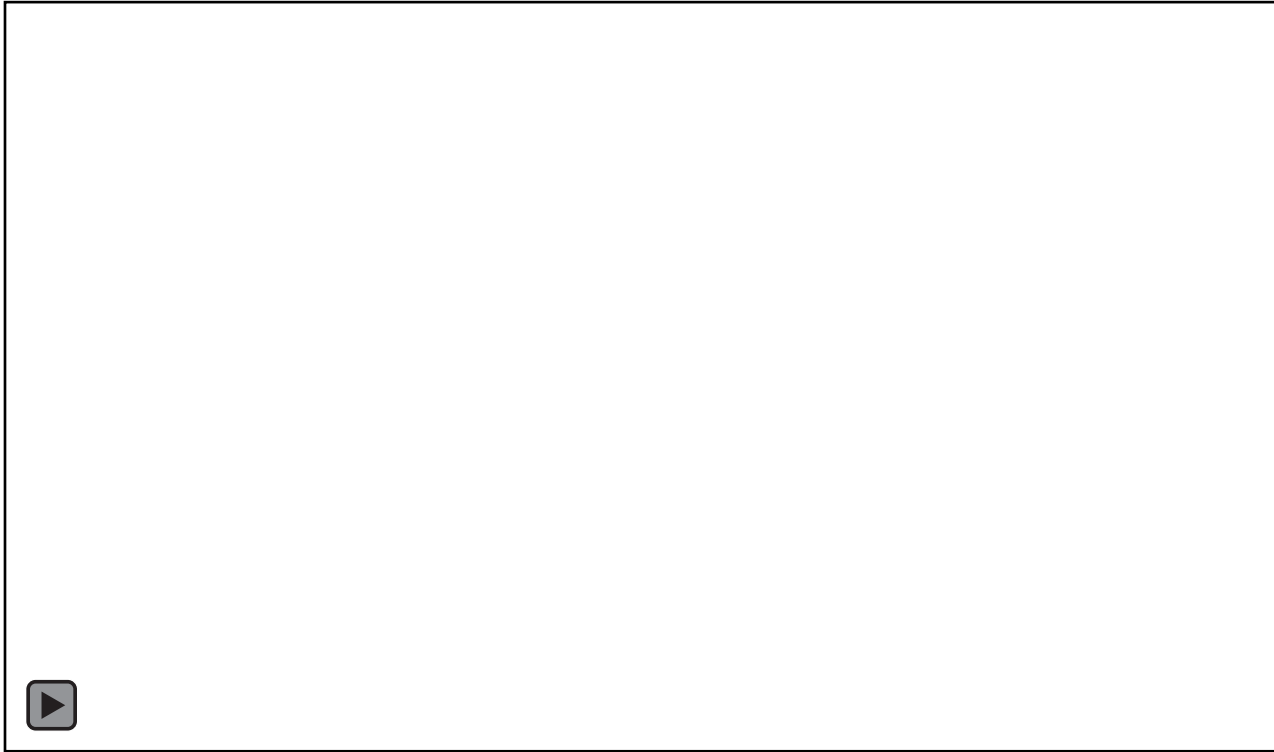

Rebar sets: Avrunding

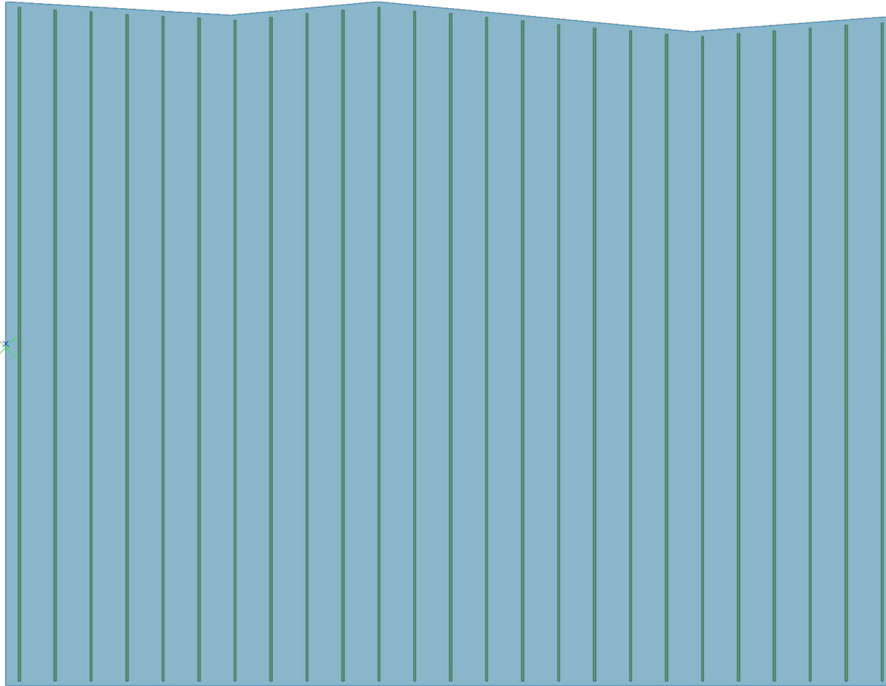

Mark	Grade	Size	Shape	Qty.	Length mm	Weight	Total kg	A
1105	Undefined	32	1	14	9750	61.6	862.4	9750
1103.1	Undefined	32	1	1	9760	61.6	61.6	9765
1103.2	Undefined	32	1	1	9780	61.7	61.7	9780
1103.3	Undefined	32	1	1	9790	61.8	61.8	9795
1103.4	Undefined	32	1	1	9810	61.9	61.9	9810
1103.5	Undefined	32	1	1	9820	62.0	62.0	9830
1103.6	Undefined	32	1	1	9840	62.1	62.1	9845
1103.7	Undefined	32	1	1	9860	62.2	62.2	9860
1103.8	Undefined	32	1	1	9870	62.3	62.3	9875
1103.9	Undefined	32	1	1	9890	62.4	62.4	9890
1103.10	Undefined	32	1	1	9900	62.5	62.5	9910
1103.11	Undefined	32	1	1	9920	62.6	62.6	9925
1103.12	Undefined	32	1	1	9940	62.8	62.8	9940
1104.1	Undefined	32	1	1	9940	62.8	62.8	9940
1104.2	Undefined	32	1	1	9920	62.6	62.6	9925
1104.3	Undefined	32	1	1	9900	62.5	62.5	9910
1104.4	Undefined	32	1	1	9890	62.4	62.4	9890
1104.5	Undefined	32	1	1	9870	62.3	62.3	9875
1104.6	Undefined	32	1	1	9860	62.2	62.2	9860
1104.7	Undefined	32	1	1	9840	62.1	62.1	9845
1104.8	Undefined	32	1	1	9820	62.0	62.0	9830
1104.9	Undefined	32	1	1	9810	61.9	61.9	9810
1104.10	Undefined	32	1	1	9790	61.8	61.8	9795
1104.11	Undefined	32	1	1	9780	61.7	61.7	9780
1104.12	Undefined	32	1	1	9760	61.6	61.6	9765
1106.1	Undefined	32	1	1	9770	61.7	61.7	9770
1106.2	Undefined	32	1	1	9800	61.9	61.9	9800
1106.3	Undefined	32	1	1	9830	62.1	62.1	9835
1106.4	Undefined	32	1	1	9860	62.3	62.2	9865
1106.5	Undefined	32	1	1	9890	62.5	62.4	9900
1106.6	Undefined	32	1	1	9930	62.7	62.7	9930
1107.1	Undefined	32	1	1	9930	62.7	62.7	9930
1107.2	Undefined	32	1	1	9890	62.5	62.4	9900

Mark	Grade	Size	Shape	Qty.	Length mm	Weight	Total kg	A
T/1	Undefined	32	1	22	9700	61.2	1346.4	9700
T/2	Undefined	32	1	8	9900	62.5	500.0	9900
T/3	Undefined	32	1	20	9800	61.9	1238.0	9800
Sum				50			3084.7	

Rebar sets: Cranking

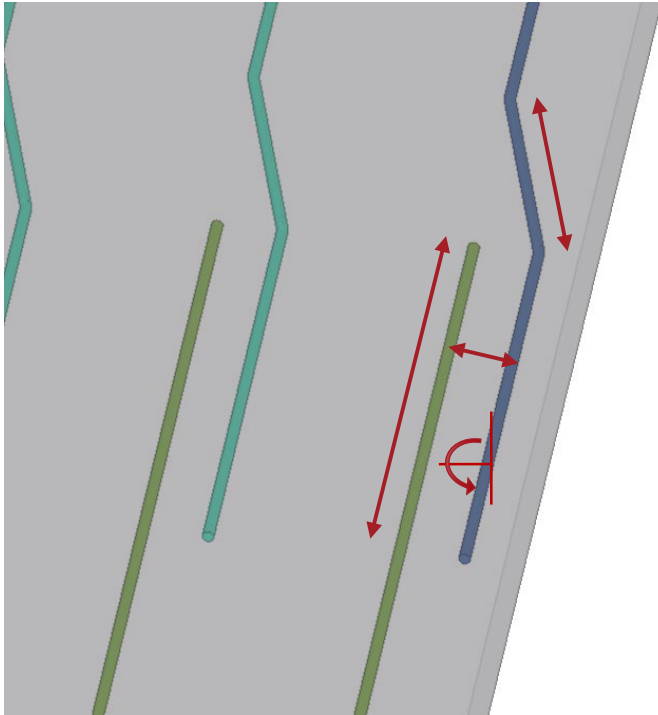

▼ Cranking

Cranking type	Custom cranking
Crank straight length	1000.00 mm
Cranked length	Diagonal distance ▼ 0.00 500.00 mm
Cranked offset	150.00 mm
Crank side	Left
Crank rotation	-90.00

Rebar sets: Cranking

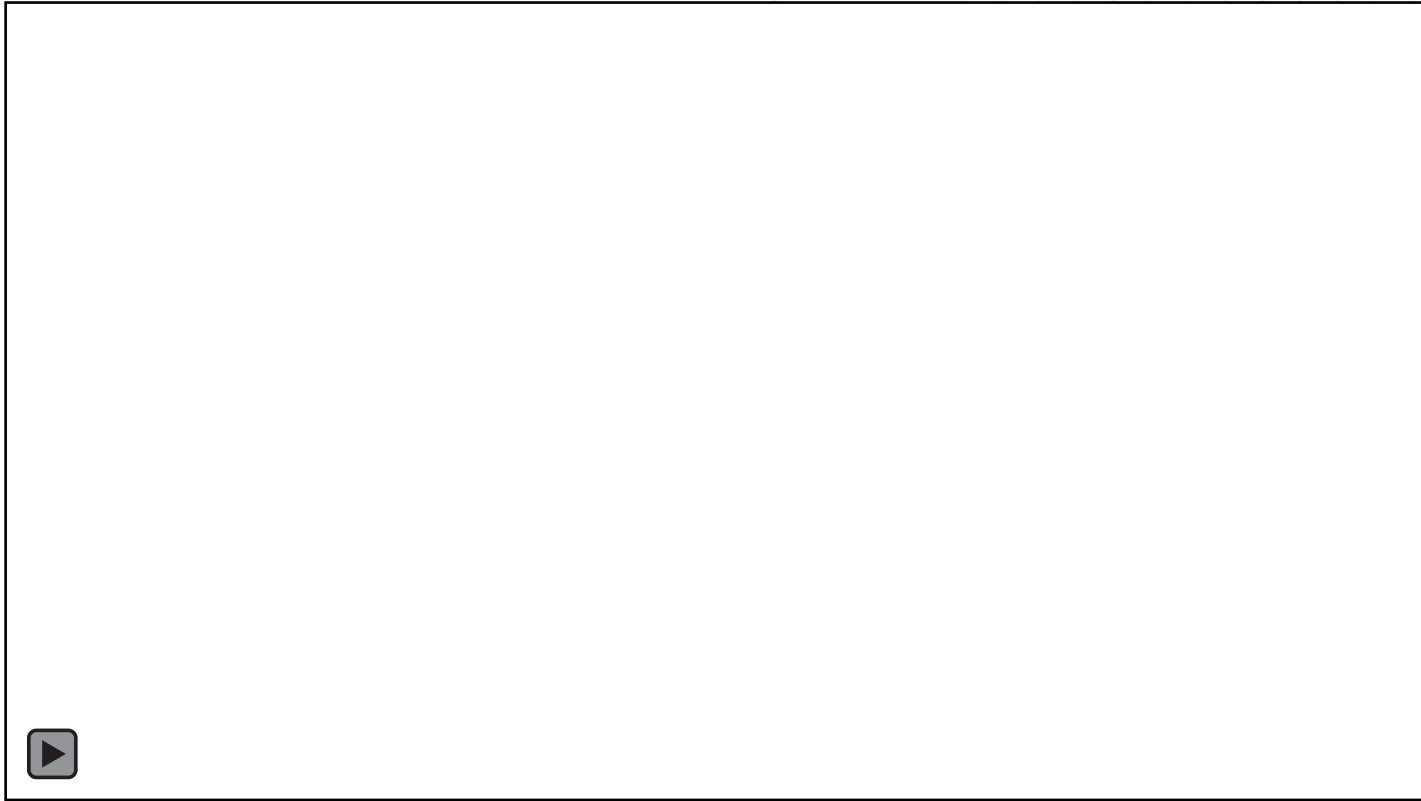

Rebar sets: End detail modifier forbedringer

- Krokk rotasjon

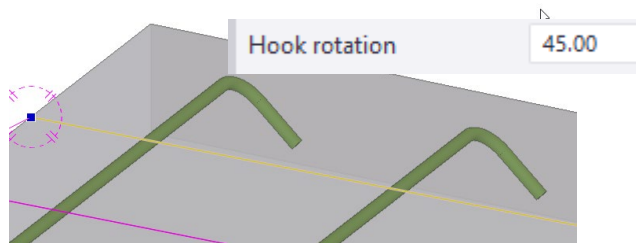

- Lengde justering

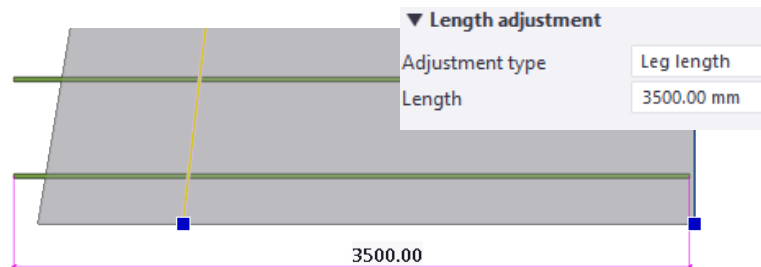
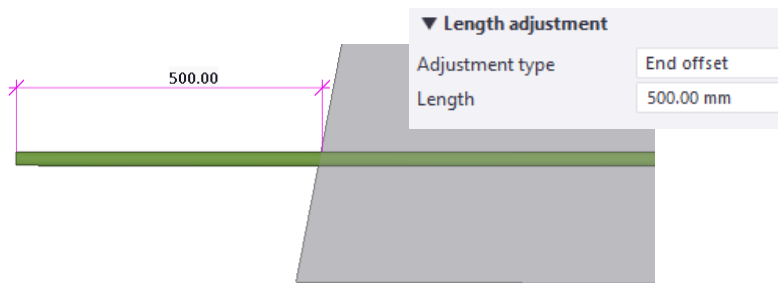

Rebar sets: End detail modifier forberdinger

- UDAs

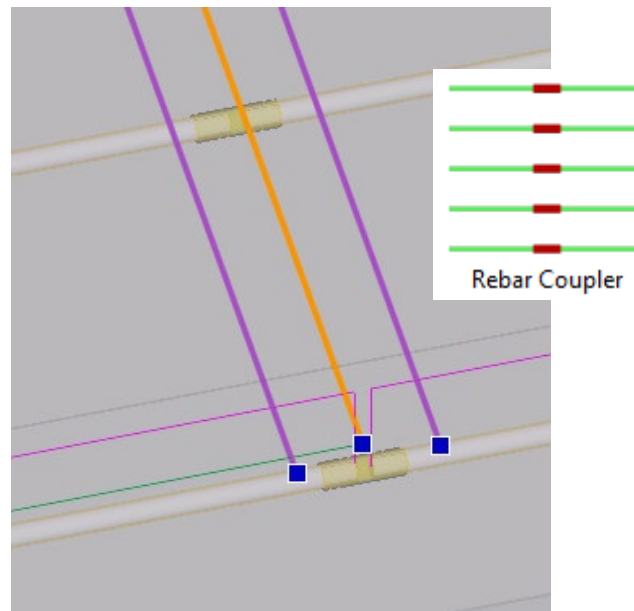
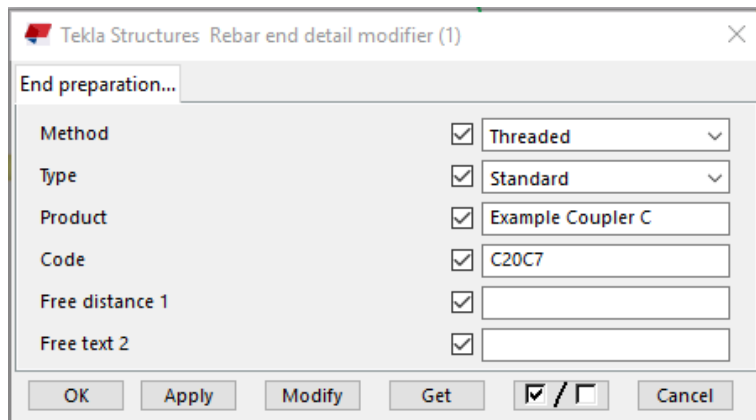

...og mye mer!

- Lett å se hvilken modifier påvirker hvilken jern

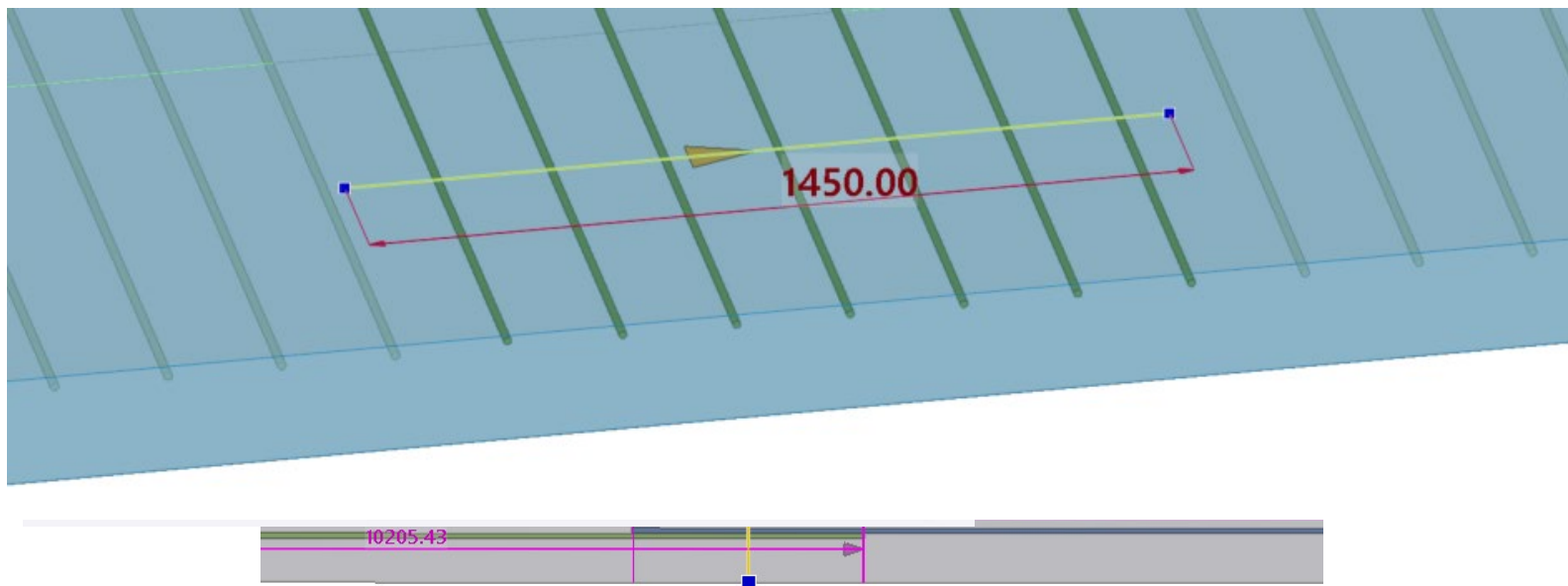

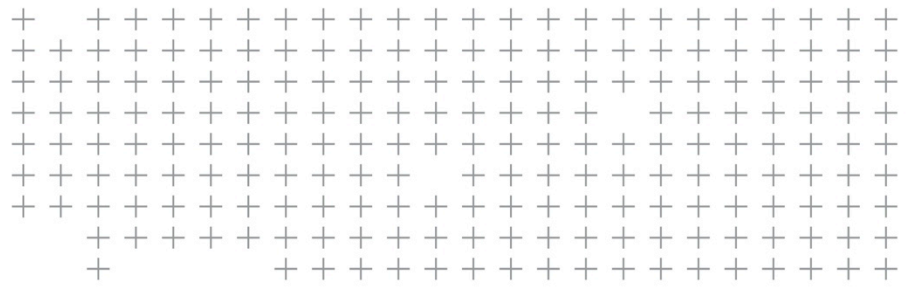

Production planning & fabrication

Production Planning

- Face lift og andre forbedringer for mer effektivt plannlegging!
 - Palletizer
 - Stacker

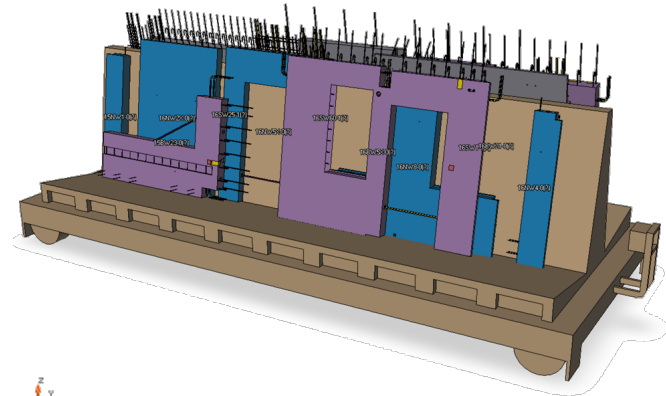
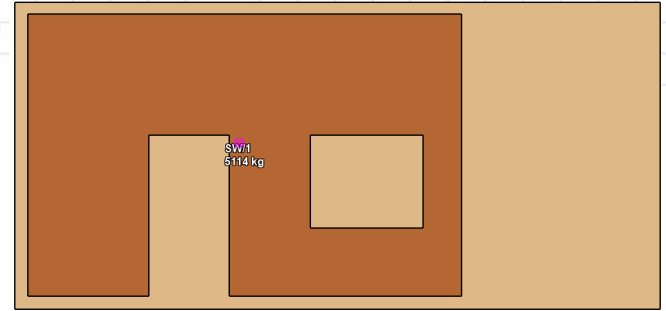

Tekla Structures Palletizer

- Versjon 2.0 forbedringer
 - Oppdatert UI (på samme måte som Stacker)
 - Pallett plassering basert på dato
 - Forbedret auto-palletizing
 - Mulighet til rotere elementer i Y-rettning
 - Flere palett typer
 - Automatisk UDA oppdatering i Tekla
 - Mer brukervenlig og bedre rapporteringsmuligheter



Tekla Structures Palletizer

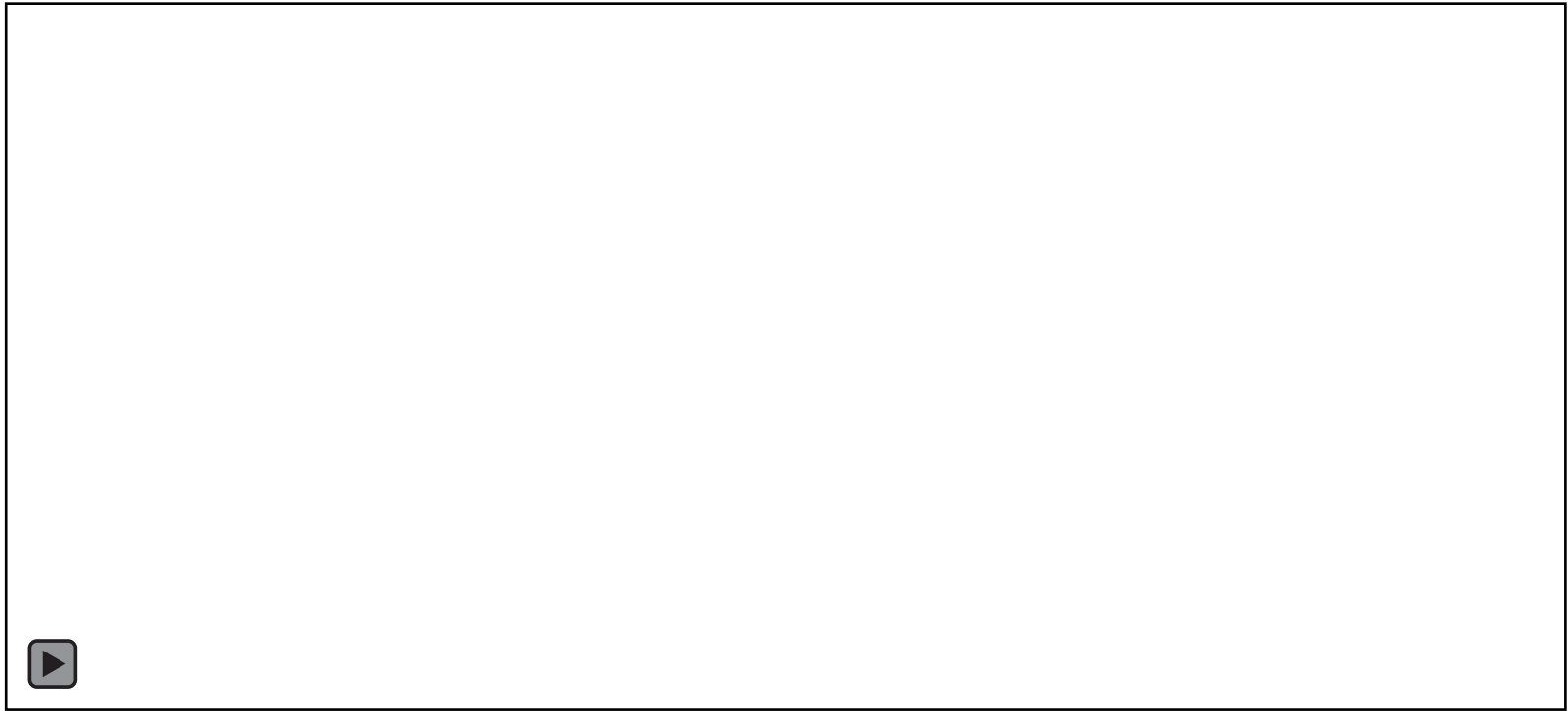

Tekla Structures Stacker

- Versjon 1.1 forbedringer
 - Flere objekt egenskaper i Stacker UI
 - Automatisk UDA oppdatering i Tekla





Tusen takk!